



**TIME BASE  
CONSOLES**

## **SM-TSS-964-P** Speaker Platform Arm

Pole mount speaker platform

The arm can fold to fit in less than 11" of space and extend out over 25"

Cable management allows for wires to clamp onto the post and tuck under the arm segments

First joint can swivel 115°, second joint and platform can rotate 360°

Shown in standard silver



### **FEATURES**

Adjustable tension at all joints

Available in 14 or 17.5" pole\*

Phenolic platform with neoprene surface available in custom sizes

Arm holds up to 22 lbs. each\*\*

Mount tilts up to 90° up and down

Standard black adapter plate for extrusion mounting included



*\* Pole extrusion available in custom lengths. Arms available in extended lengths.*

*\*\* Recommended pole weight varies by mounting method. Consult a TBC representative for accurate weight capacity before relying solely on specs.*

### **DIMENSIONS**

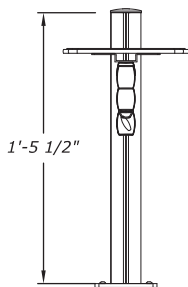

**ELEVATION**

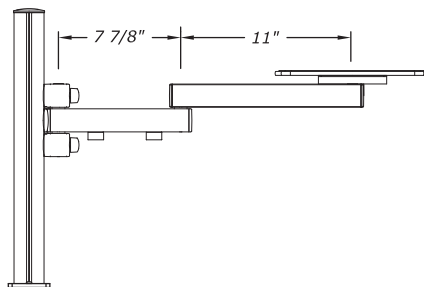

**SECTION**

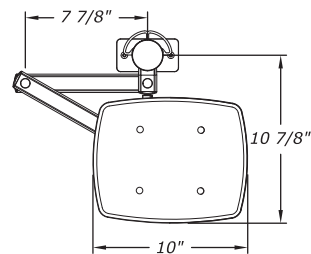

**PLAN VIEW A**

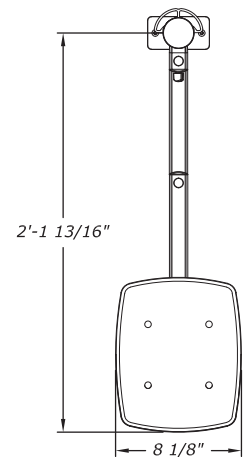

**PLAN VIEW B**